

# General Arrangement Drawing – Milton Road Bridge

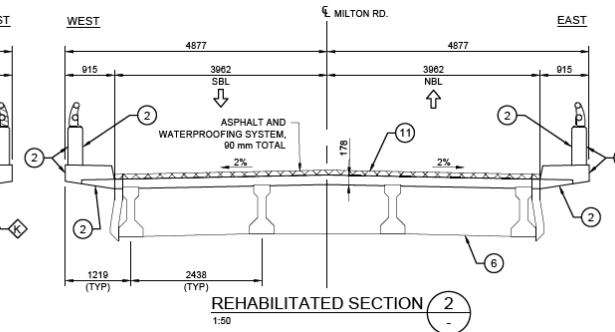
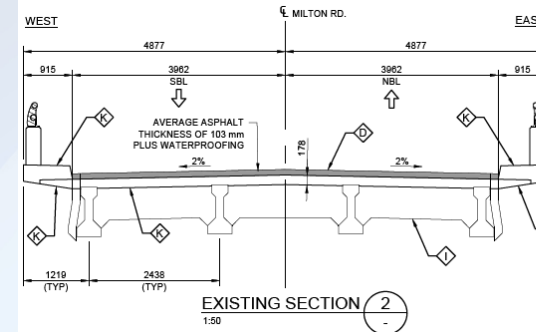
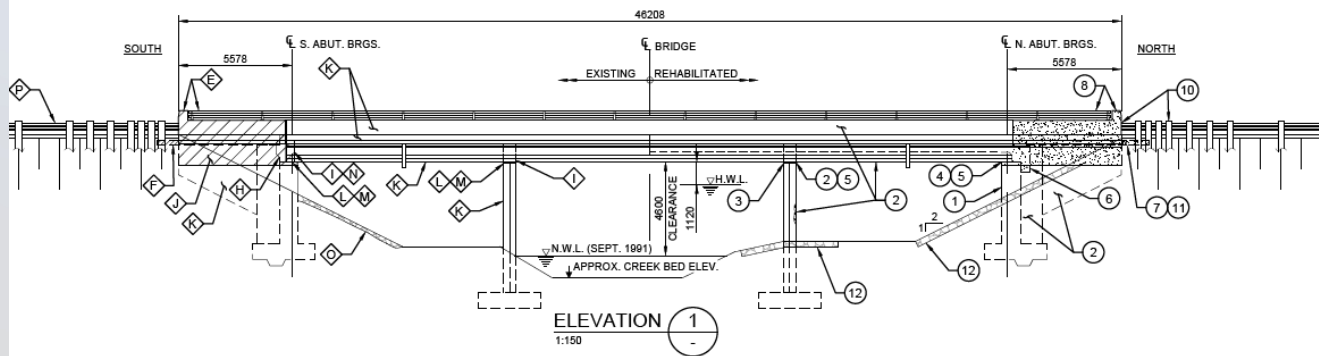
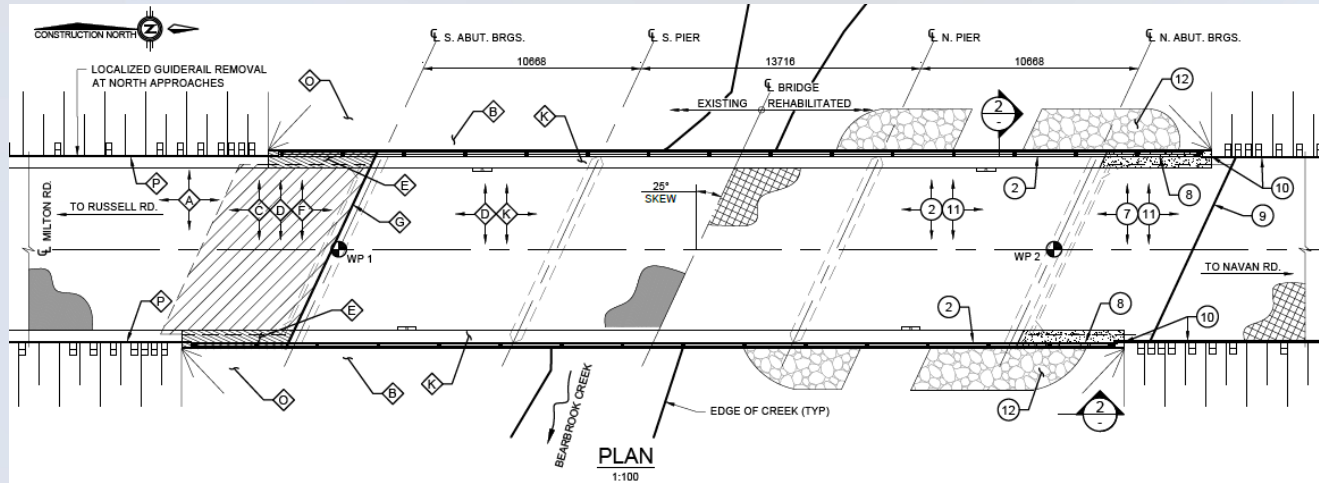

## Scope of Work

### REMOVALS: STAGE 1 AND 2 (HALF AND HALF STAGING)

- A INSTALL REQUIRED TRAFFIC CONTROL MEASURES TO RESTRICT BRIDGE TRAFFIC TO ONE LANE
- B INSTALL TEMPORARY PROTECTION/ACCESS PLATFORMS ALONG SIDE OF BRIDGE
- C INSTALL TEMPORARY ROADWAY PROTECTION SYSTEM IN BOTH APPROACHES
- D REMOVE ASPHALT AND WATERPROOFING FROM DECK AND APPROACHES
- E REMOVE CURBS AND PARAPET WALL AND RAILING ON APPROACHES
- F REMOVE EXISTING APPROACH SLABS
- G REMOVE EXISTING STRIP SEAL EXPANSION JOINT ASSEMBLIES
- H REMOVE ABUTMENT BALLAST WALLS
- I PERFORM PARTIAL DEPTH REMOVALS ON DIAPHRAGMS AT ABUTMENTS AND PIERS
- J REMOVE PORTIONS OF WINGWALLS
- K PERFORM PARTIAL DEPTH CONCRETE REMOVALS OF PIERS, WINGWALLS, DECK SOFFIT, DECK FASCIA, DECK TOP, CURBS AND GIRDERS
- L JACK AND TEMPORARILY SUPPORT BRIDGE AND REMOVE EXISTING ABUTMENT AND PIER BEARINGS
- M PERFORM PARTIAL DEPTH CONCRETE REMOVALS ON ABUTMENT AND PIER BEARING SEATS
- N REMOVE ABUTMENT DIAPHRAGMS
- O REMOVE ROCK SLOPE PROTECTION AT ABUTMENTS
- P REMOVE STEEL BEAM GUIDERAILS IN APPROACHES



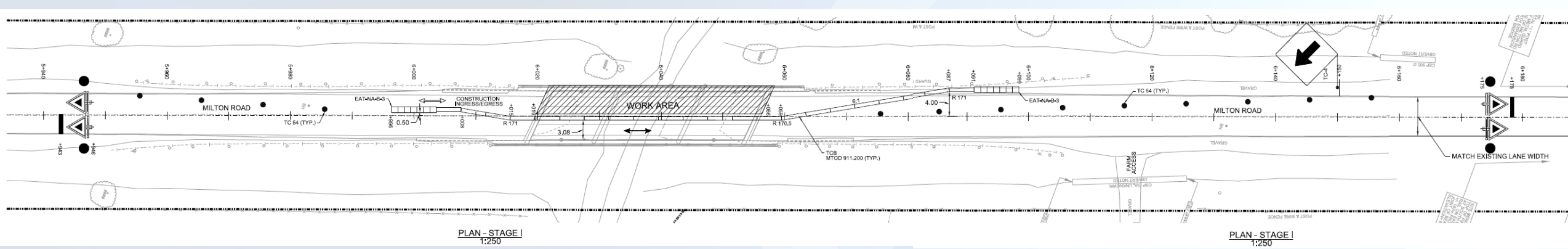

### NEW CONSTRUCTION: STAGE 1 AND 2 (HALF AND HALF STAGING)

- 1 CONSTRUCT CONCRETE FACING ON ABUTMENTS AND WINGWALLS
- 2 INSTALL TEMPORARY ACCESS MEASURES FOR ALL EXPOSED SURFACE AREAS OF PIERS, DECK SOFFIT, DECK FASCIA, DECK TOP, WINGWALLS, CURBS, GIRDERS AND DIAPHRAGMS AND PERFORM CONCRETE REPAIRS AND EPOXY CRACK INJECTION AT LOCATIONS INDICATED BY THE CONTRACT ADMINISTRATOR
- 3 STRENGTHEN ABUTMENT AND PIER DIAPHRAGMS
- 4 RECONSTRUCT ABUTMENT BEARING SEATS AND MODIFY PIER BEARING SEATS AT BEARING LOCATIONS
- 5 INSTALL NEW PIER AND ABUTMENT BEARINGS
- 6 CONSTRUCT SEMI-INTEGRAL DECK END DIAPHRAGMS AND MODIFY WINGWALLS
- 7 CONSTRUCT NEW APPROACH SLABS
- 8 CONSTRUCT NEW APPROACH BARRIER
- 9 CONSTRUCT NEW EXPANSION JOINT ASSEMBLY WITH SLEEPER SLAB AT END OF THE NORTH APPROACH
- 10 INSTALL NEW STEEL BEAM GUIDERAILS IN APPROACHES AND BARRIER-STRUCTURE CONNECTIONS
- 11 APPLY WATERPROOFING AND ASPHALT-PAVE DECK AND APPROACHES
- 12 RE-GRADE EMBANKMENTS AND INSTALL NEW RIP-RAP PROTECTION AT ABUTMENTS AND PIERS

# Traffic Management – Stage 1





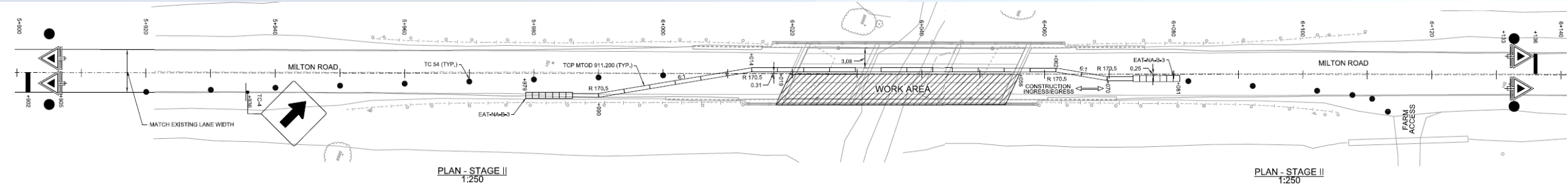

**LEGEND**

 WORK AREA	 ENERGY ATTENUATOR
 TEMPORARY CONCRETE BARRIER	 TEMPORARY TRAFFIC SIGNAL

# Traffic Management – Stage 2



## LEGEND

-  WORK AREA
-  ENERGY ATTENUATOR
-  TEMPORARY CONCRETE BARRIER
-  TEMPORARY TRAFFIC SIGNAL